

3in1

**EN/ ASTM
BABY WALKER
ROCKER
ACTIVITY CENTRE
JUMPING BOARD**

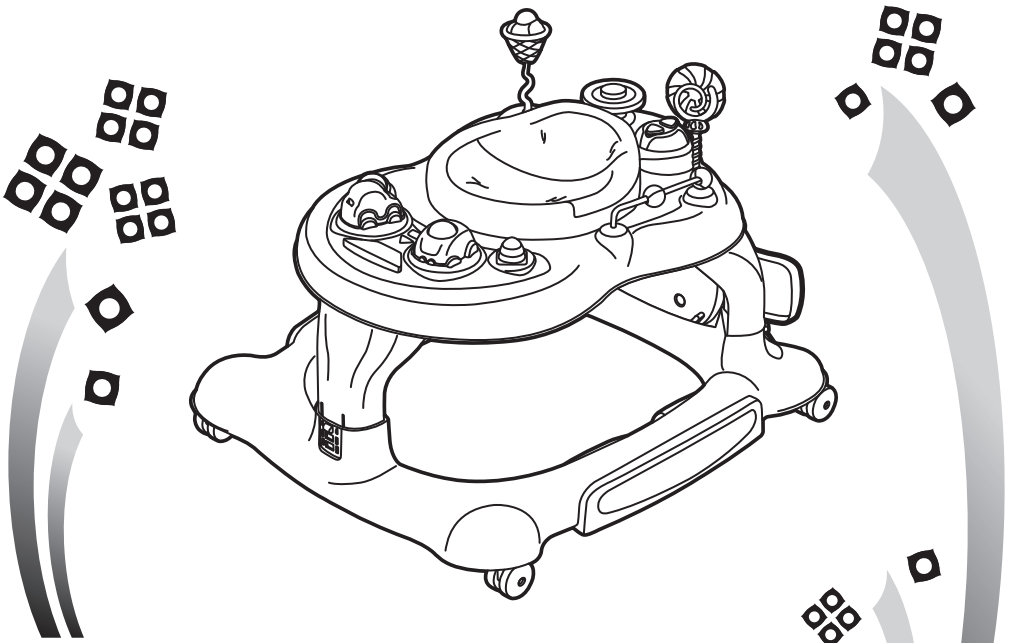

**INSTRUCTION MANUAL
IMPORTANT!
KEEP FOR FUTURE REFERENCE**

⚠️ WARNING

PLEASE READ THESE INSTRUCTIONS CAREFULLY
BEFORE USE AND RETAIN THEM IN A SAFE PLACE
FOR FUTURE REFERENCE.
READ ALL INSTRUCTIONS BEFORE ASSEMBLY
AND USE OF THE WALKER.
KEEP INSTRUCTIONS FOR FUTURE USE.
THE CHILD MAY BE HURT IF YOU DO NOT
FOLLOW THESE INSTRUCTIONS.

WARNING

“ READ THE INSTRUCTIONS CAREFULLY BEFORE USE AND KEEP THEM FOR FUTURE REFERENCE. THE CHILD MAY BE HURT IF YOU DO NOT FOLLOW THESE INSTRUCTIONS.”

NEVER LEAVE THE CHILD UNATTENDED. ALWAYS KEEP CHILD IN VIEW WHILE IN WALKER.

THE CHILD WILL BE ABLE TO REACH FURTHER AND MOVE RAPIDLY WHEN IN THE BABY WALKING FRAME:

- 1) PREVENT ACCESS TO STAIRS, STEPS AND UNEVEN SURFACES;
- 2) GUARD ALL FIRES, HEATING AND COOKING APPLIANCES;
- 3) REMOVE HOT LIQUIDS, ELECTRICAL FLEXES AND OTHER PORTENTIAL HAZARDS FROM REACH;
- 4) PREVENT COLLISIONS WITH GLASS IN DOORS, WINDOWS AND FURNITURE;
- 5) DO NOT USE THE BABY WALKING FRAME IF ANY COMPONENTS ARE BROKEN OR MISSING;
- 6) THIS BABY WALKING FRAME SHOULD BE USED ONLY FOR SHORT PERIODS OF TIME (E.G. 20 MIN);
- 7) THIS BABY WALKING FRAME IS INTENDED TO BE USED BY CHILDREN WHO CAN SIT UNAIDED, APPROXIMATELY FROM 6 MONTHS TO 36 MONTHS. IT IS NOT INTENDED FOR CHILDREN WEIGHING MORE THAN 12 KG;
- 8) DO NOT USE REPLACEMENT PARTS OTHER THAN THOSE APPROVED BY THE MANUFACTURER OR DISTRIBUTOR;
- 9) USE ONLY ON FLAT SURFACES FREE OF OBJECTS THAT COULD CAUSE THE WALKER TO TIP OVER.
- 10) DO NOT USE THE WALKER IF IT IS DAMAGED OR BROKEN.
- 11) DO NOT USE UNTIL BABY CAN SIT UP BY ITSELF.
- 12) CLEAN (FRICTION COMPONENTS) REGULARLY TO MAINTAIN STOPPING PERFORMANCE.
- 13) TO AVOID BURNS , KEEP THE CHILD AWAY FROM HOT LIQUIDS, RANGES, RADIATORS, SPACE HEATERS, FIREPLACES, ETC.
- 14) THE TOY INTENDED TO BE ASSEMBLED BY AN ADULT.

WARNING - STAIR HAZARD

AVOID SERIOUS INJURY OR DEATH BLOCK STAIRS/STEPS SECURELY BEFORE USING WALKER EVEN WHEN USING PARKING BRAKE.

- A. NON-RECHARGEABLE BATTERIES ARE NOT TO BE RECHARGED.
 - B. DIFFERENT TYPES OF BATTERIES OR NEW AND USED BATTERIES ARE NOT TO BE MIXED.
-

WARNING

- C. EXHAUSTED BATTERIES ARE TO BE REMOVED FROM THE TOY.
- D. THE SUPPLY TERMINALS ARE NOT TO BE SHORT-CIRCUITED.
- E. ONLY BATTERIES OF THE SAME OR EQUIVALENT TYPE AS RECOMMENDED ARE TO BE USED.
- F. BATTERIES ARE TO BE INSERTED WITH THE CORRECT POLARITY.
- G. HOW TO REMOVE AND INSERT REPLACEABLE BATTERIES.
- H. RECHARGEABLE BATTERIES ARE TO BE REMOVED FROM THE TOY BEFORE BEING CHARGED.
- I. IF USING RECHARGEABLE BATTERIES, THE BATTERIES ARE ONLY TO BE CHARGED UNDER ADULT SUPERVISION.

CARE AND MAINTENANCE

- 1) TO PROLONG THE LIFE OF YOUR NURSERY PRODUCT KEEP IT CLEAN AND DO NOT LEAVE IT IN THE DIRECT SUNLIGHT FOR EXTENDED PERIODS OF TIME.
- 2) REMOVABLE FABRIC COVERS AND PLASTIC PARTS MAY BE CLEANED USING WARM WATER WITH A HOUSEHOLD SOAP OR A MILD DETERGENT. ALLOW IT TO DRY FULLY, PREFERABLY AWAY FROM DIRECT SUNLIGHT.
- 3) CLEAN (FRICTION COMPONENTS) REGULARLY TO MAINTAIN STOPPING PERFORMANCE.

HELPFUL HINTS

IF THE WHEELS SQUEAK - USE A SILICON BASED SPRAY ENSURING IT PENETRATES THE WHEEL AND AXLE ASSEMBLY.

DO NOT DRY CLEAN, OR USE BLEACH.

DO NOT MACHINE WASH, TUMBLE OR SPIN DRY, UNLESS THE CARE LABELLING ON THE PRODUCT PERMITS THESE METHODS.

NON REMOVABLE FABRIC COVERS AND TRIMS MAY BE CLEANED USING A DAMP SPONGE WITH SOAP OR MILD DETERGENT. ALLOW IT TO DRY COMPLETELY BEFORE FOLDING OR STORING IT AWAY.

IN SOME CLIMATES THE COVERS AND TRIMS MAY BE AFFECTED BY MOULD AND MILDEW. TO HELP PREVENT THIS OCCURRING, DO NOT FOLD OR STORE THE PRODUCT IF IT IS DAMP OR WET. ALWAYS STORE THE PRODUCT IN A WELL VENTILATED AREA.

ALWAYS CHECK PARTS REGULARLY FOR TIGHTNESS OF SCREWS, NUTS AND OTHER FASTENERS - TIGHTEN IF REQUIRED. TO MAINTAIN THE SAFETY OF YOUR NURSERY PRODUCT, SEEK PROMPT REPAIRS FOR BENT, TORN, WORN OR BROKEN PARTS.

PARTS LIST

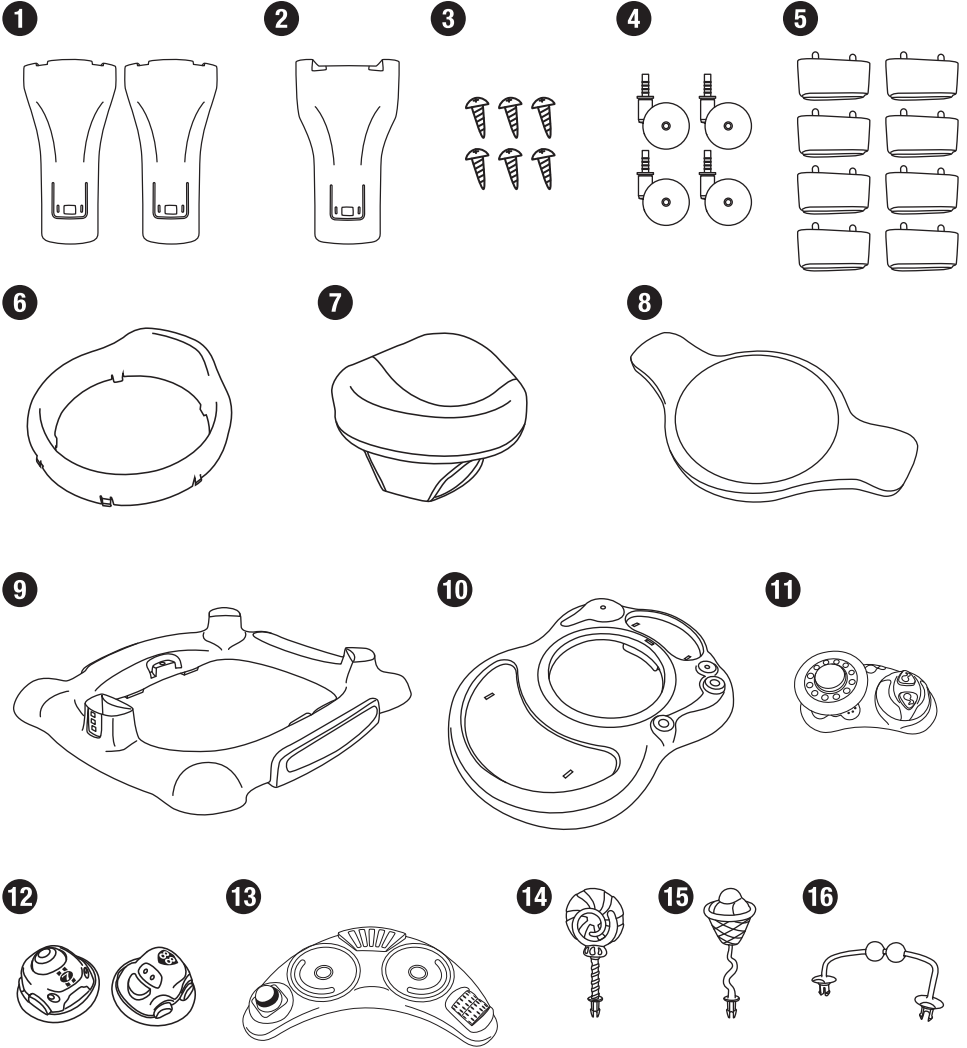

1 REAR LEGS

5 STOPPERS

9 BASE

13 CAR TOY TRAY

2 FRONT LEG

6 SEAT FRAME

10 UPPER TRAY

14 TOY LOLLIPOP

3 SCREWS

7 SEAT UNIT

11 TOY TRAY

15 TOY ICE CREAM

4 WHEELS

8 JUMPING BOARD

12 CAR TOYS

16 TOY ARCH

INSTRUCTION

A LEGS ASSEMBLY

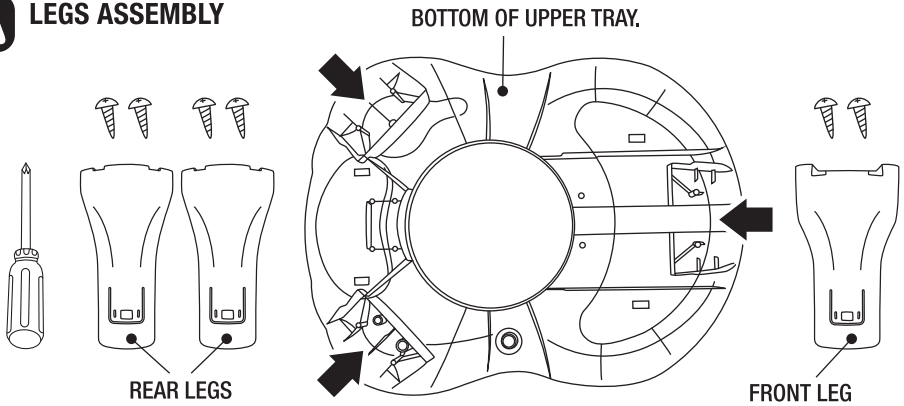

B UPPER TRAY & BASE ASSEMBLY

AFTER FASTEN THE LEGS, INSERT 3 LEGS INTO BASE UNTIL HEAR "CLICK" SOUND.

PRESS THE BUTTON TO ADJUST 3 SECTION HEIGHT. USE YOUR THUMB TO PRESS THE BUTTON AND PRESS DOWN UNTIL A "CLICK" SOUND.

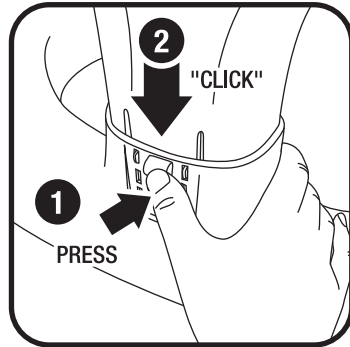
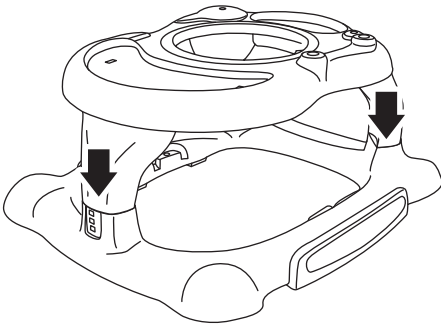

C TO FIT UP THE STOPPERS & WHEELS

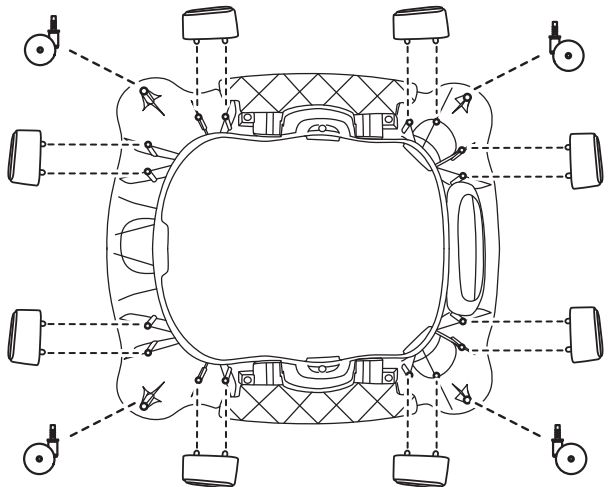
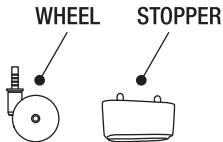

**NEVER USE THE
BABY WALKER
WITHOUT
THE WHEELS.**

INSTRUCTION

D TOYS ASSEMBLY

ALIGN KEY ON TOY TO NOTCH IN SOCKETS.

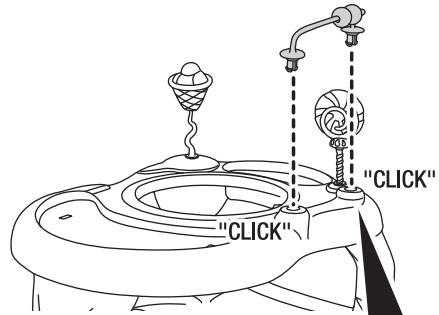
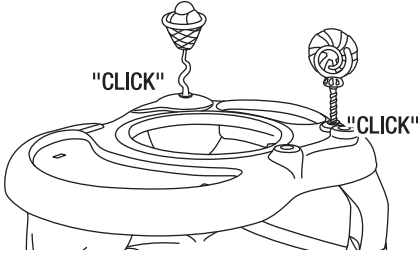

TOY ARCH

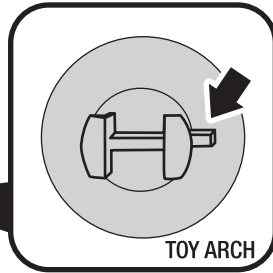
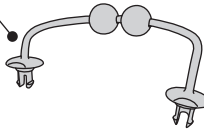

E TOY TRAYS ASSEMBLY

- BATTERIES ARE NOT SUPPLIED

CAUTION! : DO NOT RECHARGE BATTERIES. WHEN INSERTING BATTERIES OR ACCUMULATORS, MAKE SURE THE POLARITY IS CORRECT.

DO NOT MIX OLD AND NEW BATTERIES OR ACCUMULATORS. DO NOT MIX DIFFERENT KINDS OF BATTERY OR ACCUMULATOR.

ONLY USE THE TYPES OF BATTERY OR ACCUMULATOR RECOMMENDED. REMOVE USED BATTERIES OR ACCUMULATORS FROM THE TOY TRAY WHEN NOT IN USE. DO NOT SHORT-CIRCUIT THE BATTERY OR ACCUMULATOR TERMINALS. ACCUMULATORS SHOULD BE REMOVED FROM THE TOY TRAY BEFORE CHARGING WHENEVER POSSIBLE. RECHARGING ACCUMULATORS SHOULD ALWAYS BE SUPERVISED BY AN ADULT.

INSERT CAR TOYS ONTO THE TOY TRAY FIRSTLY BEFORE POSITIONING THE TOY TRAYS.

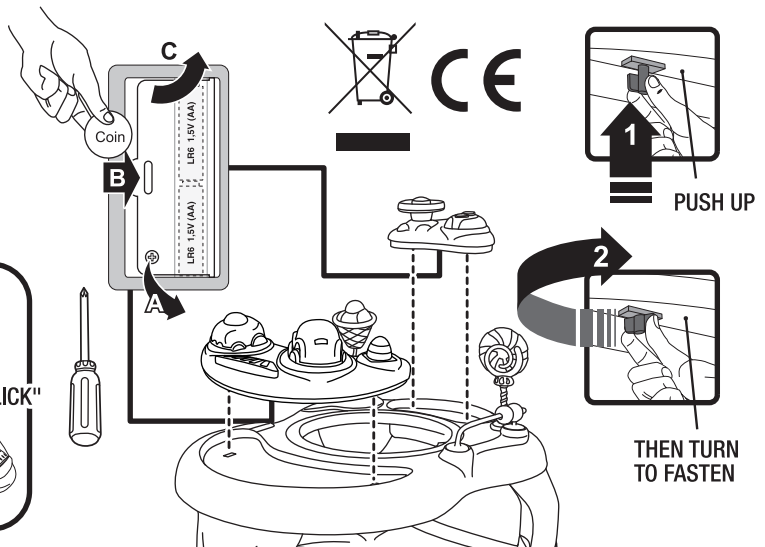
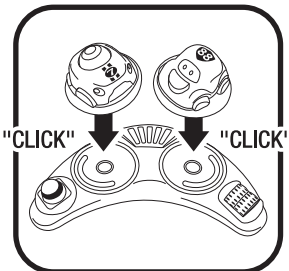

INSTRUCTION

F SEAT UNIT ASSEMBLY

FOLD THE SEAT UNIT TO COVER SEAT FRAME.

SEAT UNIT

SEAT FRAME

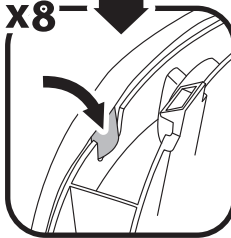
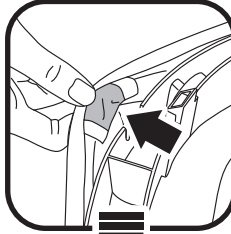
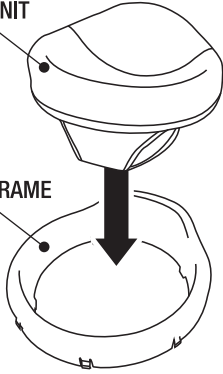

PUT SEAT FRAME ON UPPER TRAY, PRESS UNTIL HEAR "CLICK" SOUND.

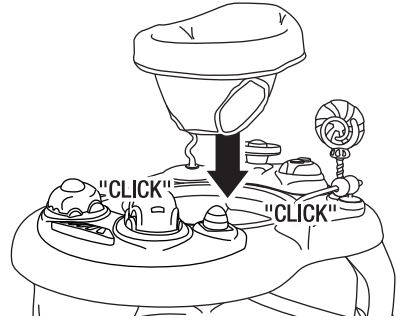

ATTENTION:
CHILDREN CAN PLAY INSIDE THE
ACTIVITY CENTRE ONLY WHEN
JUMPING BOARD IS BEING
INSTALLED INTO THE BASE.

G JUMPING BOARD ASSEMBLY

MAKE SURE THE JUMPING BOARD
FIT INTO POSITION PROPERLY
WHEN USE AS ACTIVITY
CENTRE AND ROCKER.

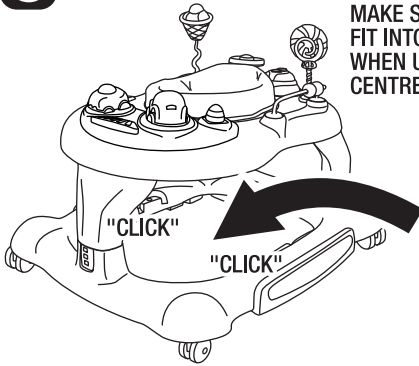

JUMPING BOARD

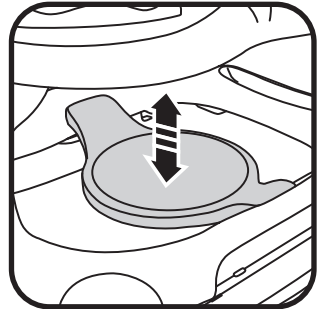
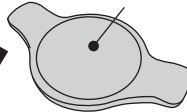

H JUMPING BOARD STORAGE

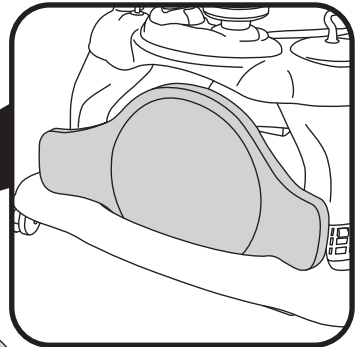
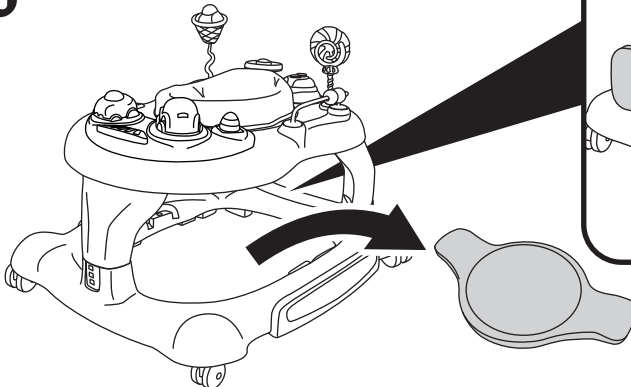

INSTRUCTION

I 360° ROTATION SEAT

PULL UP THE BUTTON TO RELEASE THE SEAT FRAME FROM FIXING POSITION.

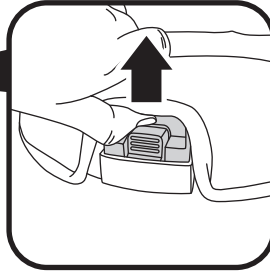
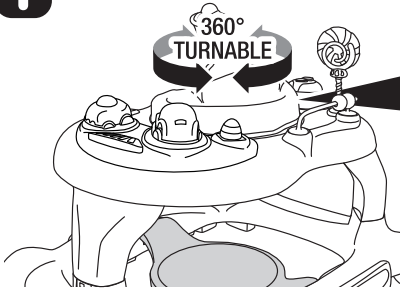

CAUTION:
JUMPING BOARD SHOULD BE IN USE.

J SEAT FRAME LOCK IN AUTOMATICALLY



PRESS THE BUTTON AND TURN THE SEAT FRAME TO THE POSITION UNTIL HEARING "CLICK" SOUND.

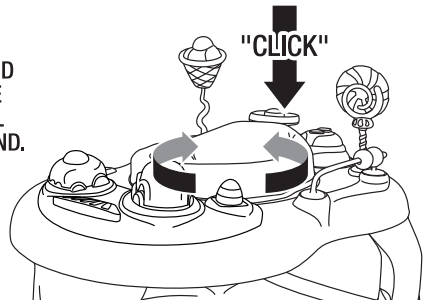

CAUTION:
THE SEAT FRAME MUST BE LOCK IN THE POSITION BEFORE USING AS A WALKER.

K ROCKER INSTALLATION

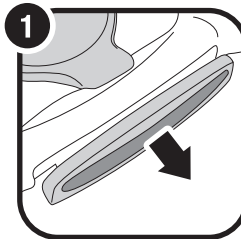
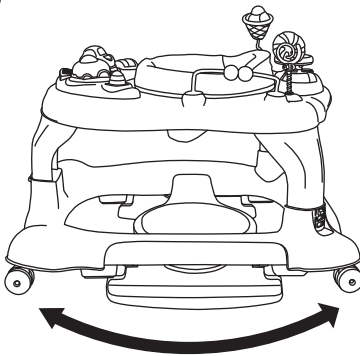

PULL OUT THE STAND FROM THE BASE.

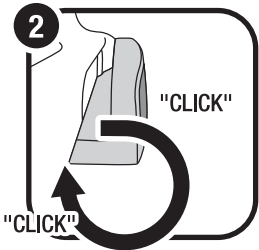

TURN THE STAND 90° UNTIL THE FRICTION PART FACING TO THE GROUND, THEN PUSH UP TO FIT IT.

CAUTION:
JUMPING BOARD SHOULD BE IN USE.